

EXHIBIT "A"
SUMMARY VACATION
OF SANITARY SEWER EASEMENT
1248 CORONA DR
GLENDALE, CALIFORNIA
(LEGAL DESCRIPTION)

BEING A PORTION OF LOTS 147 AND 148 OF TRACT NO. 6759, RECORDED IN BOOK 91, PAGES 25 THROUGH 28, INCLUSIVE OF MAP BOOKS, IN THE CITY OF GLENDALE, COUNTY OF LOS ANGELES, STATE OF CALIFORNIA, THAT PORTION BEING A STRIP OF LAND OF UNIFORM WIDTH OF 6 FEET, LYING 3 FEET EACH SIDE OF, PARALLEL AND CONTIGUOUS TO THE FOLLOWING DESCRIBED CENTERLINE, TO-WIT:

BEGINNING AT THE SOUTHWESTERLY CORNER OF SAID LOT 148;

THENCE EASTERLY ALONG THE SOUTHERLY LINES OF SAID LOT 148 A DISTANCE OF 50.18 FEET TO THE POINT OF TERMINUS, AND THE SIDELINES OF SAID EASEMENT TO BE EXTENDED OR TRIMMED TO END AT THE EASTERLY LINE OF CORONA DRIVE 25 FEET WIDE AND THE EASTERLY LINES OF LOTS 147 & 148, BOTH AS SHOWN OF SAID TRACT NO. 6759.

A PORTION OF THIS DESCRIPTION ALSO BEING DESCRIBED IN DEED RECORDED MAY 17, 1927 IN BOOK 6686, PAGE 138, OF OFFICIAL RECORDS.

THE AREA OF SAID EASEMENT TO BE QUITCLAIMED BEING APPROXIMATELY 301 SF OR 0.007 ACRES, MORE OR LESS.

AS SHOWN ON THE ATTACHED EXHIBIT "B" AND BY THIS REFERENCE MADE A PART HEREOF.

SUBJECT TO EASEMENTS, COVENANTS, CONDITIONS, RESTRICTIONS, RESERVATIONS, RIGHTS, RIGHTS OF WAY AND OTHER MATTERS OF RECORDS, IF ANY.

APN(S): 5679-016-001 & 002.

THIS DESCRIPTION/MAP HAS BEEN PREPARED
BY ME OR UNDER MY DIRECTION.

APPROVED BY CONTRACT CITY SURVEYOR
RAY LOMBERA & ASSOCIATES INC.

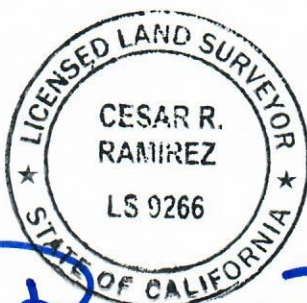

BY:

CESAR R. RAMIREZ, PLS 9266

DATE



BY:

RAY LOMBERA, PLS 7740

DATE

7-31-23